

dew drops

Design by Boris Klimek

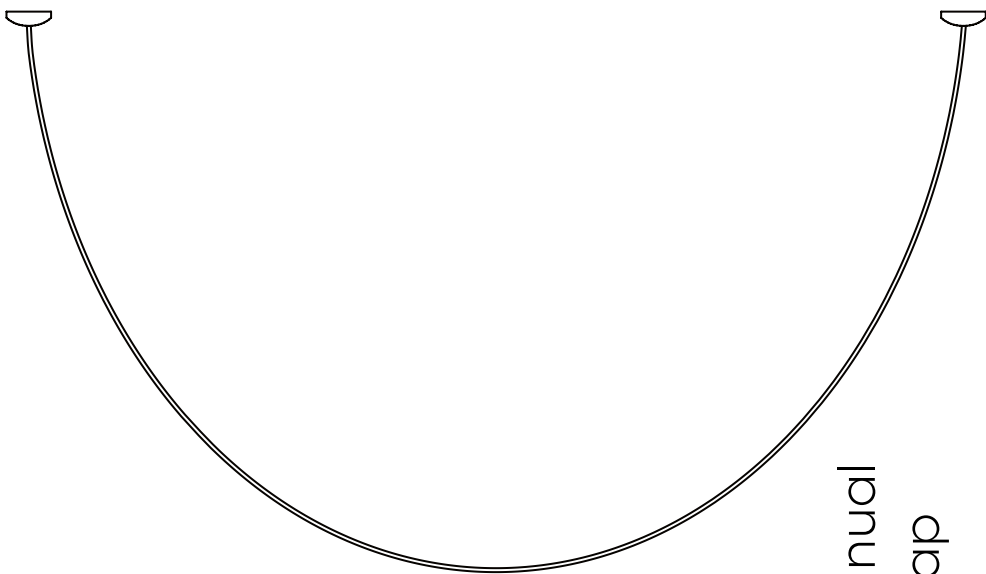

loomma

Installation Manual
for Leather Strap
Don't throw away!

Introduction

- Please, read this user's manual carefully prior to installation and follow its instructions and recommendations.
- The installation requires more than one person.
- For safety reasons, as well as for warranty purposes, it is forbidden to use this product in breach of this manual and other purposes stipulated in this manual.
- Prevent children or persons with lowered sensory or psychological abilities from handling the leather strap, as it contains small and fragile pieces that could be dangerous when inappropriately handled or ingested.
- The producer bears no liability for damage caused by improper installation.
- The surface of the mounting may also include minor imperfections due to manual production.
- The product is intended for interior.

Components included in the package

- Leather strap
- Allen key
- Installation manual
- Maintenance instructions
- Gloves

Technical parameters, specifications

- Weight: \pm 2,7 kg
- Dimensions: dia. max. 2525 mm, H max. 1205 mm

Upon opening, first check that there was no damage occurred during transport and that the light fixture is complete. Otherwise, please contact your seller immediately, as later claims may not be considered.

Assemble the product according to the manual.

Mark on the ceiling the places for fixing anchor plates ① according to Figure A. The recommended distance from the center to the center is 180-240 cm. It is important that the anchor plates are oriented exactly as shown in Figure A. The pair of holes ② for fixing the mounting shall be on the outside. After marking, fix the anchor plates to the ceiling as shown in Figure B using dowels and screws not included in the package. Choose the size and type according to the ceiling material and the weight of the product.

Figure A

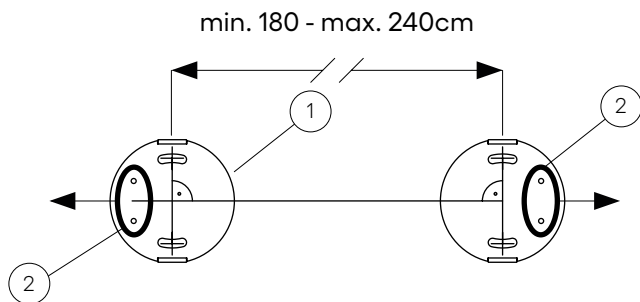
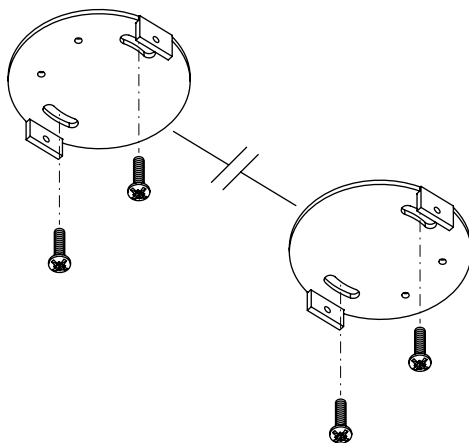

Figure B



2

Thread the first canopy (3) on the leather strap (4).
Hinges (5) must be on the upper side of the strap (Figure C).
The eccentric grooves in the two canopies shall after the installation face each other (Figure D).

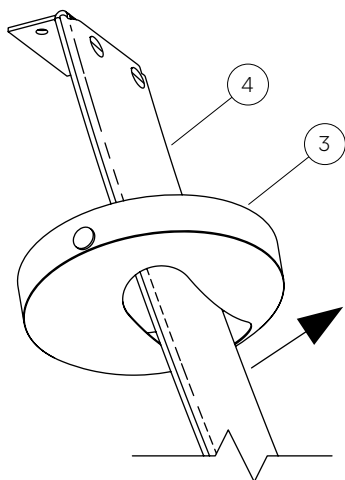

Figure C

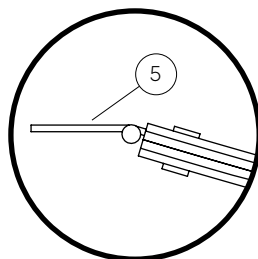
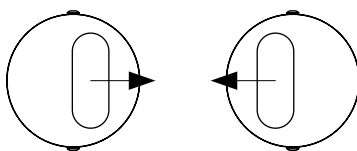
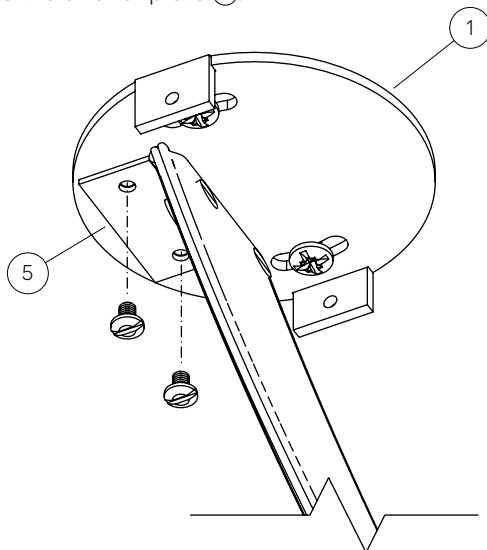

Figure D



3

Screw the hinge (5) to the anchor plate (1).



4

Thread the second canopy on the leather strap.

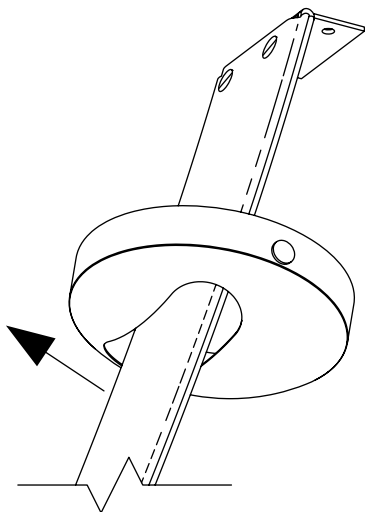

5

Screw the hinge to the anchor plate.

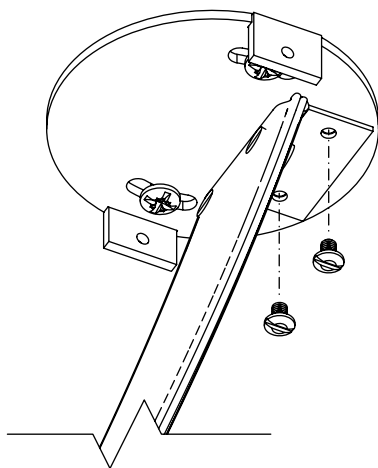

6

Slide both canopies along the strap to the ceiling and fix them to the anchor plates with a pair of screws.

Congratulations!

When disassembling proceed in the reverse order of this installation manual. Possible later transport of the product perform in either the original or comparable packaging to prevent damage.

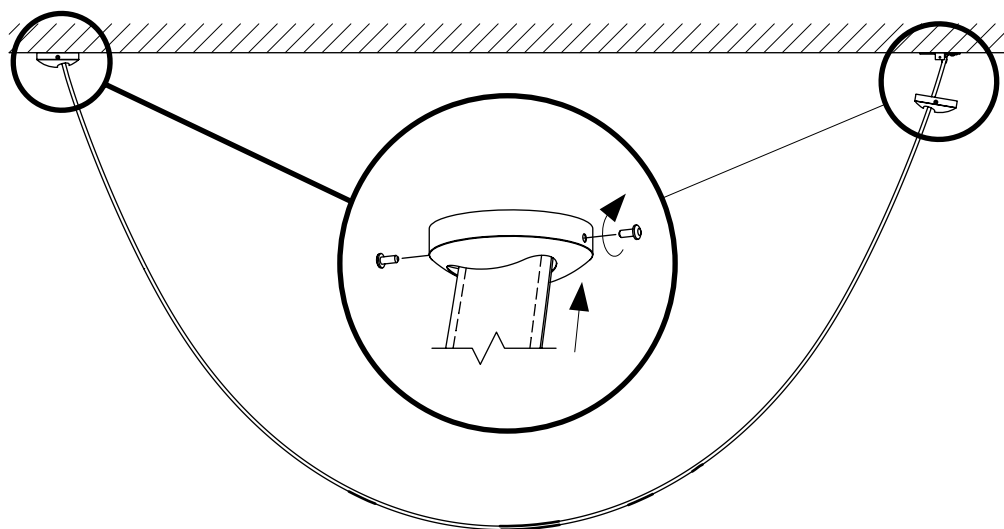

This image shows a single sheet of white paper with horizontal ruling lines. The lines are evenly spaced and run across the width of the page. There are no margins, text, or other markings on the paper.

Maintenance

- When unpacking, assembling and cleaning the product, handle the individual parts with extra care.
- The assembly of the product must be carried out by an authorized person.
- The product is intended for indoor use.
- We recommend consulting the suitability of the location and fixing of the product to the ceiling material with a project manager, an engineer or other competent person.
- Do not make any repairs or changes to the components. Contact a specialist service center.
- Do not use any spare parts which have not been supplied or approved by the manufacturer.
- Do not expose the product to an unsuitable environment where it might get damaged (water, heat, frost).
- Before servicing or cleaning the product ensure sufficient access (ladder, scaffolding, mounting platform,...) so that you can handle the product safely.
- It is recommended to hang the product at a sufficient height to avoid injury (such as head injury) to persons moving near the luminaire.
- It is recommended to install the product in more than one person.
- After installing the product, check that it is correctly and securely fixed to its base.
- Do not expose the product to unreasonable loads, protect the product from mechanical damage.
- Do not hang any other components on the product in conflict with the manufacturer's installation instructions.
- Pay attention to checking all parts before their installation.
- Contact the manufacturer if a serious problem occurs during cleaning or maintenance of the product.
- Any other manipulation with the product should be carried out by qualified personnel or directly by the manufacturer.

Cleaning

- When cleaning, wear white gloves made of soft cotton cloth. l
- Use a soft duster to clean the metal parts. Metal parts can be cleaned with dry or dampened duster in lukewarm demineralized water. When cleaning the parts, do not under any circumstances use solvents, technical gasoline, technical cleaners, peroxides or alkalis. Avoid alcoholic agents, which could cause the change of surface color.

Important notice

- The manufacturer accepts no liability for damage resulting from improper installation, improper handling of the luminaire, including installation combined with accessories other than those recommended by the manufacturer.
- The manufacturer accepts no liability for damage resulting from unprofessional tampering with the fixings and safety features of the product.
- The manufacturer reserves the right to make minor variations in the design of the product without prior notice.

Disposal

Upon the expiration of the product's shelf life, proceed in accordance to legal regulations for environmental protection and public health safety.

Waste Materials Catalog

| Number | Category | Name |
|-----------|----------|------------------------------|
| 10 11 11* | N | Waste glass |
| | | in small particles |
| | | and glass powder |
| | | containing heavy metals |
| 10 11 12 | O | Waste glass other than those |
| | | mentioned in 10 11 11 |
| 17 04 01 | O | Copper, bronze, brass |
| 17 04 05 | O | Iron and steel |
| 20 01 01 | O | Paper and cardboard |
| 15 01 05 | O | Composite packaging |

Contact

BMRC GROUP s.r.o.
Pod dráhou 1638/7, Holešovice,
170 00 Praha 7
Czech Republic
+420 569 453 149
info@bomma.cz
www.bomma.cz

Instagram bomma_cz
Facebook bommacz

bomma.cz

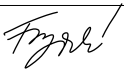
| | | | | |
|-----------------|----------------|----------|----------|--|
| drawn by | approved by | revision | date | signature |
| Karel Jankovský | Jana Fryšavská | 1 | 11. 2023 |  |

Control

Date of packaging

step beyond